

**DUBUIS**

# CATALOG



English version 

DUB24

 **PALADIN**  **LABOUNTY**  **PENGO** **STANLEY**  **DUBUIS** INDUSTRIAL TOOLS & ATTACHMENTS

**SPECIALIST IN HYDRAULIC TOOLS FOR CUTTING  
AND CRIMPING SINCE 1949**

# BATTERY DRILLING MACHINE

SNCF APPROVAL AGT21272

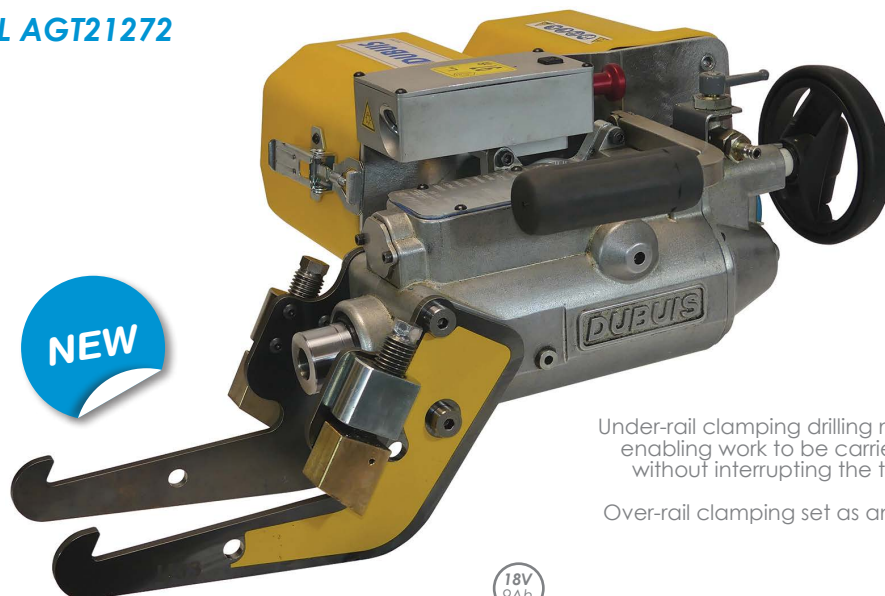

Under-rail clamping drilling machine  
enabling work to be carried out  
without interrupting the traffic

Over-rail clamping set as an option

18V  
9Ah

## DP4CC

### DRILLING CAPACITY

Reamer drills up to Ø22

Annular cutters up to Ø38  
with central spray system

### DIMENSIONS (L x l x h in mm)

910x518x431

### WEIGHT (without batteries - clamping)

19.000 kg

Delivered in carrying case with charger and 2 batteries 9.0Ah

SNCF APPROVAL AGT21273



## DP4TH

### DRILLING CAPACITY

Reamer drills up to Ø22

Annular cutters up to Ø38  
with central spray system

### DIMENSIONS (L x l x h in mm)

560x340x275

### WEIGHT

19.700 kg

Delivered in carrying case

# CRIMPING TOOLS

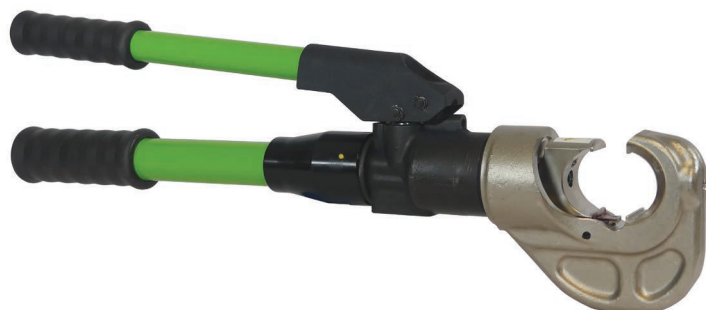

## MPL1301

<b>APPLICATIONS</b>	Hexagonal crimping 10 to 300mm <sup>2</sup>
<b>STROKE</b>	26mm 38mm available with MPL1303
<b>DIMENSIONS</b> (L x l x h in mm)	565x70x160
<b>FORCE</b>	130kN
<b>WEIGHT</b>	5.270 kg

Delivered in carrying case



INTELED™ ILLUMINATION TECHNOLOGY  
ILLUMINATES WORK AREA & PROVIDES CRIMP FEEDBACK

## NEOELEC™ BPP1303

18V  
5Ah

<b>APPLICATIONS</b>	Hexagonal crimping 10 to 400mm <sup>2</sup>
<b>PROTECTION RATING</b>	IP 44
<b>STROKE</b>	38mm 26mm available with BPP1301
<b>DIMENSIONS</b> (L x l x h in mm)	425x86x335
<b>FORCE</b>	130kN
<b>WEIGHT</b> (with battery)	7.300 kg

Delivered in carrying case with charger and 5.0Ah battery



## D36

<b>APPLICATIONS</b>	Hexagonal crimping 4 to 150mm <sup>2</sup>
<b>DIMENSIONS</b> (L x l x h in mm)	215x52x175
<b>FORCE</b>	36kN
<b>WEIGHT</b>	1.360 kg

Delivered in carrying case



## NEOELEC™ BPL036

18V  
2Ah

<b>APPLICATIONS</b>	Hexagonal crimping 4 to 150mm <sup>2</sup>
<b>DIMENSIONS</b> (L x l x h in mm)	355x75x128
<b>FORCE</b>	36kN
<b>WEIGHT</b> (with battery)	2.150 kg

Delivered in carrying case with charger and 2.0Ah battery

# CRIMPING HEADS



## XH220

<b>APPLICATIONS</b>	Crimping of overhead contact conductors up to 475mm <sup>2</sup>
<b>DIMENSIONS</b> (L x l x h in mm)	290x140x900
<b>FORCE</b>	220kN
<b>WEIGHT</b>	5.200 kg

Use with DUBUIS hydraulic power packs



## XPH1303

<b>APPLICATIONS</b>	Hexagonal crimping 10 to 400mm <sup>2</sup>
<b>STROKE</b>	38mm 26mm available with XPH1301
<b>FORCE</b>	130kN
<b>DIMENSIONS</b> (L x l x h in mm)	240x70x112
<b>WEIGHT</b>	4.300 kg

Use with DUBUIS hydraulic power packs

# HYDRAULIC POWER PACK



18V  
5Ah

## NEOELEC™ BGH701

<b>APPLICATIONS</b>	All tools requiring an external hydraulic source of 700bar
<b>DIMENSIONS</b> (L x l x h in mm)	373x60x260
<b>PRESSURE</b>	700bar
<b>WEIGHT</b> (with battery)	6.000 kg

Delivered in carrying case with charger and 5.0Ah battery, remote control and oil can.  
This power pack is designed for intermittent use due to its optimal weight and compactness.

SNCF APPROVAL AGT22526



18V  
5Ah

NEW

## NEOELEC™ BGH702 BGH701 backpack version

<b>APPLICATIONS</b>	All tools requiring an external hydraulic source of 700bar. Outdoors
<b>PROTECTION RATING</b>	IP 54 (Backpack version)
<b>DIMENSIONS</b> (L x l x h in mm)	500x160x300
<b>PRESSURE</b>	700bar
<b>WEIGHT</b> (with battery)	7.100 kg

Delivered in carrying case with charger and 5.0Ah battery.  
This power pack is designed for intermittent use due to its optimal weight and compactness.



## PHE706

<b>APPLICATIONS</b>	All tools requiring an external hydraulic source of 700bar
<b>DIMENSIONS</b> (L x l x h in mm)	380x200x420
<b>PRESSURE</b>	700bar
<b>WEIGHT</b>	17.000 kg

Delivered in carrying case with remote control and oil can.  
This power pack is designed for intensive use.

# MULTITOOLS



Also available in BPE063 and BPL063



## NEOELEC™ BPP063

18V  
5Ah

<b>APPLICATIONS</b>	This tool accepts crimping, cable cutting and punching heads
<b>PROTECTION RATING</b>	IP 44
<b>DIMENSIONS</b> (L x l x h in mm)	295x86x335
<b>FORCE</b>	62kN
<b>WEIGHT</b> (with battery, without head)	4.000 kg

Delivered in carrying case with charger and 5.0Ah battery.



## XCM050

<b>APPLICATIONS</b>	Copper and aluminum cutting up to Ø50,8mm (2 inches)
<b>DIMENSIONS</b> (L x l x h in mm)	275x66x125
<b>WEIGHT</b>	2.350 kg



## XGM025

<b>APPLICATIONS</b>	Steel, copper and aluminum cutting up to Ø25mm
<b>DIMENSIONS</b> (L x l x h in mm)	185x85x55
<b>WEIGHT</b>	1.950 kg



## XCM008

<b>APPLICATIONS</b>	Threaded rod up to M10 Mild steel bar up to Ø8mm
<b>DIMENSIONS</b> (L x l x h in mm)	245x75x50
<b>WEIGHT</b>	1.600 kg

Delivered with straight blades and curved blades.

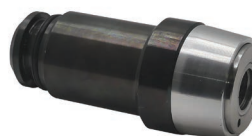

## XHM062

<b>APPLICATIONS</b>	Round punch up to Ø63.5mm Square punch up to 50.8x50.8mm Rectangular punch up to 36x86mm
<b>DIMENSIONS</b> (L x l x h in mm)	Ø54x120
<b>WEIGHT</b>	1.000 kg

# MULTITOOLS



## XPM062

<b>APPLICATIONS</b>	Hexagonal crimping 6 to 300mm <sup>2</sup>
<b>DIMENSIONS</b> (L x l x h in mm)	170x56x100
<b>WEIGHT</b>	1.800 kg



## XPM060F

Flip-top 4 indents, Dieless crimping

<b>APPLICATIONS</b>	Copper Connectors 10 to 400mm <sup>2</sup> (8AWG to 750Kcmil) Aluminum Connectors 10 to 300mm <sup>2</sup> (8AWG to 600Kcmil)
<b>DIMENSIONS</b> (L x l x h in mm)	265x65x135
<b>WEIGHT</b>	3.100 kg



## XDM041

<b>APPLICATIONS</b>	107mm <sup>2</sup> and 150mm <sup>2</sup> copper, copper-cadmium, copper-tin and copper-magnesium contact wires
<b>DIMENSIONS</b> (L x l x h in mm)	213x184x196 (with removable handle)
<b>WEIGHT</b>	4.100 kg



## XPM061

<b>APPLICATIONS</b>	Hexagonal crimping DIN 48083-1 dies Copper/Aluminum 6 to 185mm <sup>2</sup> (240mm <sup>2</sup> , please consult us)
<b>DIMENSIONS</b> (L x l x h in mm)	170x56x100
<b>WEIGHT</b>	1.900 kg



## XCMDIN

<b>APPLICATIONS</b>	Steel Omega DIN rail cutter, Steel G DIN rail cutter, Copper grounding Oblong punching for M6
<b>DIMENSIONS</b> (L x l x h in mm)	220x55x100
<b>WEIGHT</b>	2.700 kg



## XCMSTRU

<b>APPLICATIONS</b>	STRUT rail galvanized steel cutter 41x21, 41x41 up to 2.5mm
<b>DIMENSIONS</b> (L x l x h in mm)	290x90x115
<b>WEIGHT</b>	6.300 kg

# CATENARY MAINTENANCE



NEOELEC™  
**BDL041**

18V  
2Ah

#### APPLICATIONS

Kink remover: contact wires 107mm<sup>2</sup> and 150mm<sup>2</sup> copper, copper-cadmium, copper-tin and copper-magnesium

**DIMENSIONS** (L x l x h in mm) 375x80x210

**FORCE** 40kN

**WEIGHT** (with battery) 4.950 kg

Delivered in carrying case with charger and 2.0Ah battery



NEOELEC™  
**BR020**

18V  
2Ah

#### APPLICATIONS

Dropper claw setting and removing tool  
Remove pins from claws 4001, 4006...

**DIMENSIONS** (L x l x h in mm) 350x180x290

**FORCE** 20kN

**WEIGHT** (with battery) 5.200 kg

Delivered in carrying case with charger and 2.0Ah battery



## TEMPORARY OVERHEAD CONTACT DROPPER

#### APPLICATIONS

1500V rail networks with auxiliary bearer cable.

**DIMENSIONS** (L x l x h in mm) 373x60x260

**WEIGHT** 0.330 kg



# SWITCH ROD HEAD TELESCOPIC POLE



## TPU2

<b>APPLICATIONS</b>	750V, 1 500V, 3 000V, 15 000V and 25 000V rail networks
<b>SHORT-CIRCUIT WITHSTAND STRENGTH</b>	80 000A
<b>WEIGHT</b>	1.160 kg

Optional: Contact braid replacement kit



## TPU-TRAM

<b>APPLICATIONS</b>	750V and 1 500V rail networks
<b>SHORT-CIRCUIT WITHSTAND STRENGTH</b>	35 000A
<b>WEIGHT</b>	0.920 kg

Optional: Contact braid replacement kit



## PITM

<b>APPLICATIONS</b>	750V, 1 500V, 3 000V, 15 000V and 25 000V rail networks
<b>LENGTH</b>	2.15m to 5.60m (7.60m with extension)
<b>WEIGHT</b>	3.500 kg

Red tube: foam-covered upper tube (standard IEC 60855-1)  
White tubes: hollow middle and lower tubes (standard IEC 61235)













## PIM-TRAM

<b>APPLICATIONS</b>	750V networks and more
<b>LENGTH</b>	1.30m + 2.20m to 3.90m (5.90m with extension)
<b>WEIGHT</b>	1.200 kg + 2.600 kg

Red tube: foam-covered upper tube (standard IEC 60855-1) + reflective signalling cone  
White tubes: Hollow middle and lower tubes (standard IEC 61235)

# ELECTRICAL CONNECTION TO THE RAIL

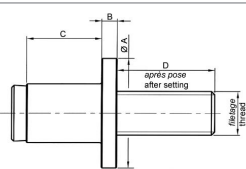

THREAD	M6	M6	M10	M10	M10
<b>DRILLING DIAMETER</b> (mm)	Ø 8 > 8.2	Ø 8.5 > 8.7	Ø 13.5 > 13.7	Ø 13.5 > 13.7	Ø 13.5 > 13.7
<b>RAIL WEB THICKNESS</b>	17 mm max.	17 mm max.	17 mm max.	17 mm max.	15 mm min.
<b>PACKAGING</b> M6 BOX OF 20 BONDS + FASTENING M10 BOX OF 10 BONDS + FASTENING					
<b>BOND PART No.</b>	30996	30989	77911	81974	80913
<b>APPROVAL</b>			<b>SNCF:</b> 7.952.0882	<b>SNCF:</b> 7.952.1513	<b>SNCF:</b> 7.952.0900
<b>BUSHING MATERIAL</b>	Tin-plated copper	Tin-plated copper	Tin-plated copper	Tin-plated copper	Tin-plated copper
<b>BUSHING LENGTH</b>	17 mm	17 mm	17 mm	15.5 mm	6.5 mm
<b>HARDWARE</b>					
<b>CONTACT SURFACE</b>	427 mm <sup>2</sup>	453 mm <sup>2</sup>	721 mm <sup>2</sup>	640 mm <sup>2</sup>	275 mm <sup>2</sup>
<b>REAMER DRILL ADAPTER</b>	30776	80312 86070	86225 86859	86225 86859	86225 86859
<b>SETTING TOOL</b>	PH1IN	PH1IN	PH3IN	PH3IN	PH3IN
<b>TORQUE WRENCH + SOCKET</b>	80997 +OFACR10	80997 +OFACR10	80967 +OFACS16H	80967 +OFACS16H	80967 +OFACS16H
<b>TORQUE VALUE</b>	10 Nm	10 Nm	40 Nm	40 Nm	40 Nm
	<b>DIMENSIONS</b> (mm)	Ø A	25	25	25
		Ø B	3.5	3.5	3.5
	Ø C	17	17	15.5	6.5
	Ø D	23	23	23	23
	<b>WEIGHT</b>		51 gr	46 gr	35 gr
<b>ELECTRICAL SPECIFICATIONS</b>	<b>TOTAL ELECTRICAL RESISTANCE</b>		12 µΩ	12 µΩ	12 µΩ
	<b>ELECTRICAL RESISTANCE OF THE BOND – RAIL CONTACT</b>		4 µΩ	5 µΩ	6 µΩ
<b>ELECTRICAL TESTS</b>	<b>ABILITY TO WITHSTAND HEATING</b>		Current between 1000 & 1500 A for 50 minutes (train passing 10 times).		
	<b>SHORT-CIRCUIT WITHSTAND STRENGTH</b>		3 short-circuit tests at 7000 A 0.2s		
	<b>CORROSION RESISTANCE</b>		300 hours in salt mist (NFX41002)		
<b>OTHER TESTS</b>	<b>ABILITY TO WITHSTAND VIBRATION</b>		Acceleration from 7 to 16 g along 3 axes, 8 hours per axis.		
	<b>RESISTANCE TO THERMAL SHOCK</b>		-30°C / +70°C		
	<b>RESISTANCE TO PRESSURE</b> (coloured water)		No leakage before: 250 Bar.		
<b>APPLICATION EXAMPLE</b>			<b>Traction current return/Signalling</b>	<b>AD connection</b>	<b>Double connection</b>

# ELECTRICAL CONNECTION TO THE RAIL



THREAD	M12	M12D	M12	M16
<b>DRILLING DIAMETER</b> (mm)	Ø 19 > 19.2	Ø 19 > 19.2	Ø 22 > 22.2	Ø 22 > 22.2
<b>RAIL WEB THICKNESS</b>	17 mm max.	16 – 18 mm	22 mm max.	22 mm max.
<b>PACKAGING</b> BOX OF 10 BONDS + FASTENING				
<b>BOND PART No.</b>	80917 / 77918	77928	30987	30986
<b>APPROVAL</b>			<b>RAILTRACK</b>	<b>RAILTRACK</b>
<b>BUSHING MATERIAL</b>	Tin-plated copper	Tin-plated copper	Tin-plated copper	Tin-plated copper
<b>BUSHING LENGTH</b>	17 mm	15.5 mm	22 mm	22 mm
<b>HARDWARE</b>				
<b>CONTACT SURFACE</b>	1014 mm <sup>2</sup>	925 mm <sup>2</sup>	1451 mm <sup>2</sup>	1451 mm <sup>2</sup>
<b>REAMER ANNULAR CUTTER</b> <b>ADAPTER</b>	80396 80373	80396 80373	80365 80373	80365 80373
<b>SETTING TOOL</b>	PH4IN	PH4IN + draw stud 78410	PH4IN	PH6IN
<b>TORQUE WRENCH + SOCKET</b>	80967 +OFACS18H	80967 +OFACS18H	80967 +OFACS18H	80968 +OFACS24H
<b>TORQUE VALUE</b>	80 Nm	80 Nm	80 Nm	150 Nm
<b>DIMENSIONS</b> (mm)	Ø A Ø B Ø C Ø D	30 4 17.5 24	30 4 15.5 24	35 5 22 37
(in rail thickness 16.5 mm)				
<b>WEIGHT</b>	93 gr	190 gr	122 gr	165 gr
<b>ELECTRICAL SPECIFICATIONS</b>				
<b>TOTAL ELECTRICAL RESISTANCE</b>	15 µΩ	15 µΩ	10 µΩ	10 µΩ
<b>ELECTRICAL RESISTANCE OF THE BOND – RAIL CONTACT</b>	5 µΩ	5 µΩ	3 µΩ	3 µΩ
<b>ELECTRICAL TESTS</b>				
<b>ABILITY TO WITHSTAND HEATING</b>	1h00 at 250 A + 2h30 at 500 A + 1h30 at 2000 A			1000 cycles of 5 minutes at 2800A Constant current 8 hours at 1000A
<b>SHORT-CIRCUIT WITHSTAND STRENGTH</b>				3 short-circuit tests at 34 000 A 1 s
<b>OTHER TESTS</b>				
<b>RESISTANCE TO THERMAL SHOCK</b>				-30°C / +70°C
<b>APPLICATION EXAMPLE</b>	<b>Tramway</b>			

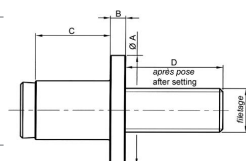

# SETTING TOOLS FOR RAIL BONDS



## XPH3INP - XPH4INP - XPH6INP

<b>XPH3INP</b>	M10 rail bonds setting
<b>XPH4INP</b>	M12 rail bonds setting
<b>XPH6INP</b>	M16 rail bonds setting
<b>HEAD DIMENSIONS</b> (L x Ø in mm)	88x58
<b>XPH3INP FORCE</b>	27kN
<b>XPH4INP FORCE</b>	37kN
<b>XPH6INP FORCE</b>	60kN
<b>WEIGHT</b> (tool and hose)	2.000 kg
<b>WEIGHT</b> (head)	1.300 kg



RAIL BONDS

Delivered in canvas bag



NEOELEC™

## XPH3INE - XPH4INE - XPH6INE

<b>XPH3INE</b>	M10 rail bonds setting
<b>XPH4INE</b>	M12 rail bonds setting
<b>XPH6INE</b>	M16 rail bonds setting
<b>HEAD DIMENSIONS</b> (L x Ø in mm)	88x58
<b>XPH3INE FORCE</b>	27kN
<b>XPH4INE FORCE</b>	37kN
<b>XPH6INE FORCE</b>	60kN
<b>WEIGHT</b> (tool with battery and hose)	2.800 kg
<b>WEIGHT</b> (head)	1.300 kg

Delivered with charger and 2.0Ah battery

# SETTING TOOLS FOR EARTH BONDS



EARTH BONDS

## MTPMXX

<b>APPLICATIONS</b>	M5 M6 M8 and M10 setting Male threaded earth bond and female grounding range
<b>DIMENSIONS</b> (L x l x h in mm)	192x52x207
<b>FORCE</b>	Adjustable 6 to 25kN
<b>WEIGHT</b>	1.440 kg

Delivered in carrying case with M6, M8 and M10 screwed connection and M6, M8 and M10 nose



18V  
2Ah

## NEOLEC™ BTEMXX

<b>APPLICATIONS</b>	M5 M6 M8 and M10 setting Male threaded earth bond and female grounding range
<b>DIMENSIONS</b> (L x l x h in mm)	373x60x260
<b>FORCE</b>	Adjustable 6 to 25kN
<b>WEIGHT</b> (with battery)	3.440 kg

Delivered in carrying case with charger and 2.0Ah battery, M6, M8 and M10 screwed connection and M6, M8 and M10 nose

# CUTTING TOOLS WITH BATTERY



This tool is not made for cutting cables



## NEOELEC™ BCP008C

18V  
5Ah

18V  
2Ah

<b>APPLICATIONS</b>	Up to Ø8 rebar Up to M10 threaded rod
<b>PROTECTION RATING</b>	IP 44
<b>DIMENSIONS</b> (L x l x h in mm)	455x86x335
<b>FORCE</b>	24kN
<b>WEIGHT</b>	4.600 kg

Delivered in carrying case with charger and 5.0Ah battery



Do not cut live cables



## NEOELEC™ BCL035i

<b>APPLICATIONS</b>	Multi-strand copper/aluminum
<b>DIMENSIONS</b> (L x l x h in mm)	107x78x445
<b>FORCE</b>	43kN
<b>WEIGHT</b> (with battery)	3.300 kg

Delivered in carrying case with charger and 2.0Ah battery



Do not cut live cables



18V  
5Ah

## NEOELEC™ BCP085G

<b>APPLICATIONS</b>	Telecom & Underground Cable up to Ø85mm Copper up to 4x240mm <sup>2</sup> + 1x120mm <sup>2</sup>
<b>DIMENSIONS</b> (L x l x h in mm)	580x86x340
<b>FORCE</b>	70kN
<b>PROTECTION RATING</b>	IP 44
<b>WEIGHT</b> (with battery)	8.800 kg

Delivered in carrying case with charger and 5.0Ah battery

# CUTTING TOOLS WITH BATTERY



Do not cut live cables



18V  
5Ah

NEOELEC™  
**BCP016C**

<b>APPLICATIONS</b>	Up to Ø16 rebar Up to M18 threaded rod
<b>PROTECTION RATING</b>	IP 44
<b>DIMENSIONS</b> (L x l x h in mm)	585x160x430
<b>FORCE</b>	80kN
<b>WEIGHT</b> (with battery)	11.000 kg

Delivered with charger and 5.0Ah battery



Do not cut live cables



18V  
5Ah

NEOELEC™  
**BCP017C**

<b>APPLICATIONS</b>	Up to Ø16 rebar Up to M18 threaded rod
<b>PROTECTION RATING</b>	IP 44
<b>DIMENSIONS</b> (L x l x h in mm)	1025x160x430
<b>FORCE</b>	80kN
<b>WEIGHT</b> (with battery)	11.800 kg

Delivered with charger and 5.0Ah battery



Distributed by:

**DUBUIS**

17 - 19 Rue Jules Berthonneau  
C.S. 73406 - ZI de Villebarou  
41034 BLOIS CEDEX  
FRANCE

Tel.: +33 (0)2 54 52 40 00  
E-mail: [commercial@dubuis.com](mailto:commercial@dubuis.com)  
[www.dubuis.com](http://www.dubuis.com)  
[www.industrialtoolsandattachments.com](http://www.industrialtoolsandattachments.com)

EN 9100  
ISO 9001  
ISO 14001  
ISO 45001  
BUREAU VERITAS  
Certification

